

CORNER RECORD

Agency Index

BK 125 PG 66

Document Number CR 12869

City of Berkeley

County of Alameda, California

Brief Legal Description B2288, B2289 & B2290 City Monuments northerly of APN 55-1862-59, Canyon Rd.

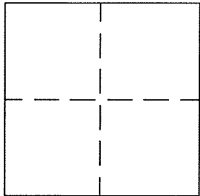

CORNER TYPE

Government Corner ☐ Control ☒
Meander ☐ Property ☐
Rancho ☐ Other ☐

Date of Survey 01/28/2018

COORDINATES (Optional)

N: E:

Elevation: B2289=504.46'

Units: Metric ☐ U.S. Survey Foot ☒

Horizontal Datum

Zone Epoch Date

Vertical Datum City of Berkeley (CoB)

☐ Complies with Public Resources Code §§ 8801-8819☐ Complies with Public Resources Code §§ 8890-8902PLS Act Ref: ☐ 8765(d) ☒ 8771 ☐ 8773 ☐ Other:

Corner/
Monument: ☒ Left as found ☐ Established ☐ Rebuilt ☒ Pre-Construction
☐ Found and tagged ☐ Reestablished ☒ Referenced ☐ Post-Construction

Narrative of corner identified and monument as found, set, reset, replaced, or removed:

☒ See sheet #2 for description(s): FOUND(2) 7/8" IRON ROD FLUSH, CITY MONUMENTS B2288/B2289 & FOUND(1) 1" IRON PIPE WITH ILLEGIBLE TAG, CITY MONUMENT B2290, PER RECORD OF SURVEY 528, BOOK 9, PAGES 92-97.

REFERENCE MONUMENTS WERE FOUND, SET & MEASURED TO PERPETUATE EXISTING MONUMENT PURSUANT TO THE PLS ACT SECTION 8771 PRIOR TO CONSTRUCTION. NO CLAIM IS MADE REGARDING THE CORRECTNESS OF THE POSITIONS OF SAID MONUMENTS, NOR THE DIMENSIONAL RELATIONSHIP TO STREET CENTERLINES OR PROPERTY BOUNDARIES.

SURVEYOR'S STATEMENT

This Corner Record was prepared by me or under my direction in conformance with

the Professional Land Surveyors' Act on February 4th, 2019.

Signed Mark E. Reinhardt P.L.S. No. 6392

COUNTY SURVEYOR'S STATEMENT

This Corner Record was received 10/11, 2019

and examined and filed 10/11, 2019.

Signed D. Ian Wilson P.L.S. or ~~P.L.S.~~ No. 7010Title County Surveyor

County Surveyor's Comment

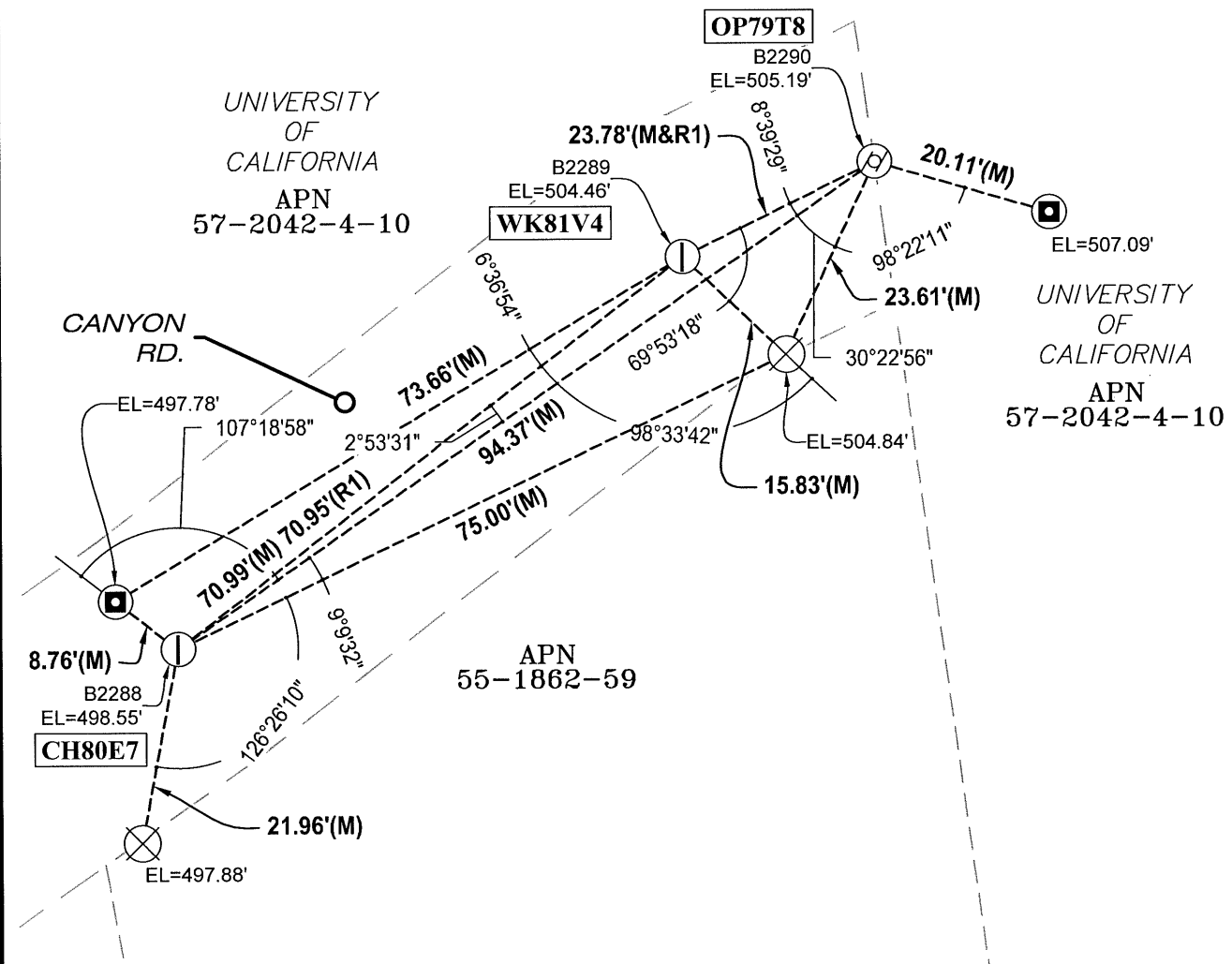

**LEGEND**

- M = MEASURED
 R = RECORD
 (1) = FOUND 7/8" IRON ROD FLUSH per (R1)
 (2) = FOUND 1" IRON PIPE WITH TAG ILLEGIBLE per (R1)
 (X) = SET 1-1/4" BRASS DISK MARKED "PLS 6392"
 (3) = SET 3/4" IRON PIPE WITH ALUMINUM CAP MARKED "PLS 6392 CP"

REFERENCE

(R1) Record of Survey 528
 -Book 9, Pages 92-97

NOTES

Elevations on reference points
 were established using a Sokkia
 B20 Automatic 32X level.

AA##A#

- ALAMEDA COUNTY MONUMENT ID

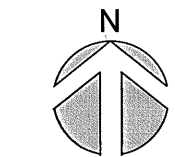

0 10' 20'

SCALE: 1"=20'