

CORNER RECORD

Agency Index

BK 126 PG 67

Document Number

CR 13430

City of EDEN TOWNSHIP

County of ALAMEDA, California

Brief Legal Description MONUMENT LOCATED WITHIN SEVEN HILLS RD IN FRONT OF 3682 SEVEN HILLS RD

CORNER TYPE

COORDINATES (Optional)

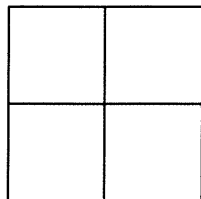

Government Corner ☐ Control ☒
Meander ☐ Property ☐
Rancho ☐ Other ☐

N. _____ E. _____

Elevation _____

Units Metric ☐ U.S. Survey Foot ☐

Horizontal Datum _____

Zone _____ Epoch Date _____

Vertical Datum _____

☐ Complies with Public Resources Code §§8801-8819☐ Complies with Public Resources Code §§8890-8902

Date of Survey 8/20/19

PLS Act Ref: ☐ 8765(d) ☒ 8771 ☐ 8773 ☐ Other:

Corner/Monument: ☒ Left as found ☐ Established ☐ Rebuilt ☒ Pre-Construction
☐ Found and tagged ☐ Reestablished ☒ Referenced ☐ Post-Construction

Narrative of corner identified and monument as found, set, reset, replaced, or removed:

☐ See sheet #2 for description(s):

FOUND 1-1/4" SQUARE BOLT WITH PUNCH

MONUMENT FOUND 1.2' BELOW GRADE. EXCAVATED PRIOR TO REFERENCING.

FOUND AND SET POINTS AS SHOWN ON PAGE 2.

THIS POINT WAS REFERENCED PRIOR TO A CONSTRUCTION PROJECT IN THE VICINITY.

THE TIES SHOWN HEREON ARE FOR THE PURPOSE OF PERPETUATING FOUND MONUMENTATION.

NO CLAIM IS MADE AS TO THE RELATIONSHIP OF THE POINTS OR LINES SHOWN HEREON TO TRUE BOUNDARY LOCATION.

SURVEYOR'S STATEMENT

This Corner Record was prepared by me or under my direction in conformance with

the Professional Land Surveyors' Act on AUGUST 26, 2019.

Signed Scott V. Cunha P.L.S. or R.C.E. No. LS 8525
SCOTT V. CUNHA

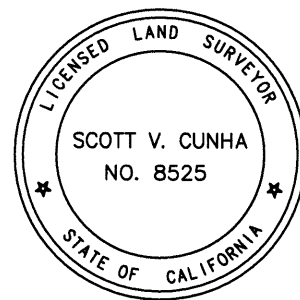

COUNTY SURVEYOR'S STATEMENT

This Corner Record was received SEP 03 2019,

and examined and filed OCT 31 2019.

Signed D. Ian Wilson P.L.S. or R.C.E. No. 7010

Title ALAMEDA COUNTY SURVEYOR

County Surveyor's Comment

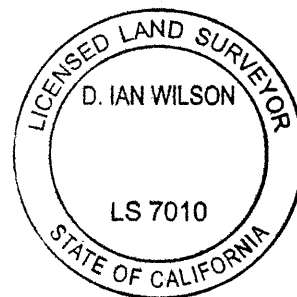

SPEC-2379-Pre

SCALE: 1"=30'

LEGEND

- FOUND 1-1/4" SQUARE BOLT WITH PUNCH
- ⊗ SET CUT CROSS IN DRIVEWAY
- SET REBAR & CAP STAMPED "CEI RP"
- 19592 REFERENCE STREET ADDRESS

