

# RECORD of SURVEY

for

JORDAN VANNINI and MANDY PFEIFFER, trustees of the  
Jordan Vannini and Mandy Pfeiffer Revocable Family Trust  
dated July 9, 2012  
20160003993

BEING A PORTION OF THE SE 1/4 SECTION 2, T. 7 N., R. 12 E., M. D. M.  
COUNTY OF AMADOR, STATE OF CALIFORNIA

**Toma & Associates Inc.**  
ENGINEERING - SURVEYING - PLANNING  
41 Summit Street, Jackson, CA 95642  
(209) 223-0156

Scale: 1"=40'

December, 2016

## SURVEYOR'S STATEMENT

THIS MAP CORRECTLY REPRESENTS A SURVEY MADE BY ME OR UNDER MY DIRECTION IN CONFORMANCE WITH THE REQUIREMENTS OF THE PROFESSIONAL LAND SURVEYORS ACT AT THE REQUEST OF JORDAN VANNINI IN OCTOBER OF 2016.

DATE: December 12, 2016

  
CIRO L. TOMA P.L.S. 3570  
MY LICENSE EXPIRES 6-30-2018

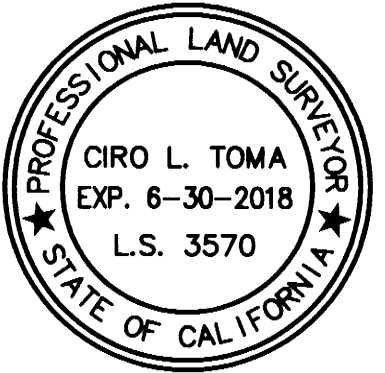

## COUNTY SURVEYOR'S STATEMENT

THIS MAP HAS BEEN EXAMINED IN ACCORDANCE WITH SECTION 8766 OF THE PROFESSIONAL LAND SURVEYORS ACT THIS 21<sup>ST</sup> DAY OF December, 2016.

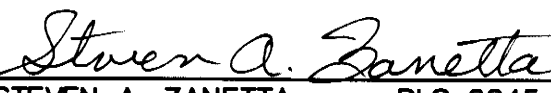
  
STEVEN A. ZANETTA PLS 6245  
AMADOR COUNTY SURVEYOR  
MY LICENSE EXPIRES 3-31-2018



## RECORDER'S STATEMENT

FILED THIS 22<sup>nd</sup> DAY OF December, 2016 AT 1:22 P.M.  
IN BOOK 64 OF MAPS AND PLATS AT PAGE 89 AT THE REQUEST OF  
THE AMADOR COUNTY SURVEYOR.

FEE: \$100.00 pd. filed

INSTRUMENT No.: 2016-0010320

  
KIMBERLY L. GRADY  
AMADOR COUNTY RECORDER

BY:

DEPUTY

## NOTES and LEGEND

- DENOTES 3/4" REBAR WITH PLASTIC CAP STAMPED PLS 3570 SET ON THIS SURVEY
- DENOTES FOUND 5/8" REBAR WITH CAP STAMPED LS 5257 PER 64-M-30
- ⊗— DENOTES FOUND 3/4" REBAR TAGGED LS 2902 PER 63-M-86
- ⊙— DENOTES FOUND 3/4" REBAR TAGGED RCE 10761 IN RECORD LOCATION CITED AS LS 2902 PER 64-M-30, 63-M-86 AND 12-M-67
- ⊖— DENOTES SET SURVEY MARK SPIKE WITH CAP STAMPED PLS 3570
- ⊗— DENOTES FOUND BENT 5/8" REBAR, NO TAG
- DENOTES A CALCULATED POINT ONLY, NOTHING FOUND OR SET
- ( ) DENOTES RECORD DATA PER 64-M-30 AND/OR 63-M-86
- ( )<sup>a</sup> DENOTES RECORD DATA PER 20160003993
- ( )<sup>b</sup> DENOTES RECORD DATA PER 12-M-67
- RW DENOTES RIGHT-OF-WAY OR DISTANCE TO RIGHT-OF-WAY
- CL DENOTES CENTERLINE OR DISTANCE TO CENTERLINE

BASIS OF BEARINGS IS REFERRED TO THE EAST LINE OF THE "ROUNSEVILLE TRUST" PARCEL AS SHOWN ON 63-M-86, THE BEARING OF WHICH IS N 01°55'10" E.

