

Apr. 06, 2021 — 4:36pm Plotted By: kurt.joecker V:\028410-CFT — Master 2020\028410-02-Cincinnati_OH-04-DWG) Ena Sheet\CD\028410-02-SHVS-CB40.dwg Layout: Grad Plan

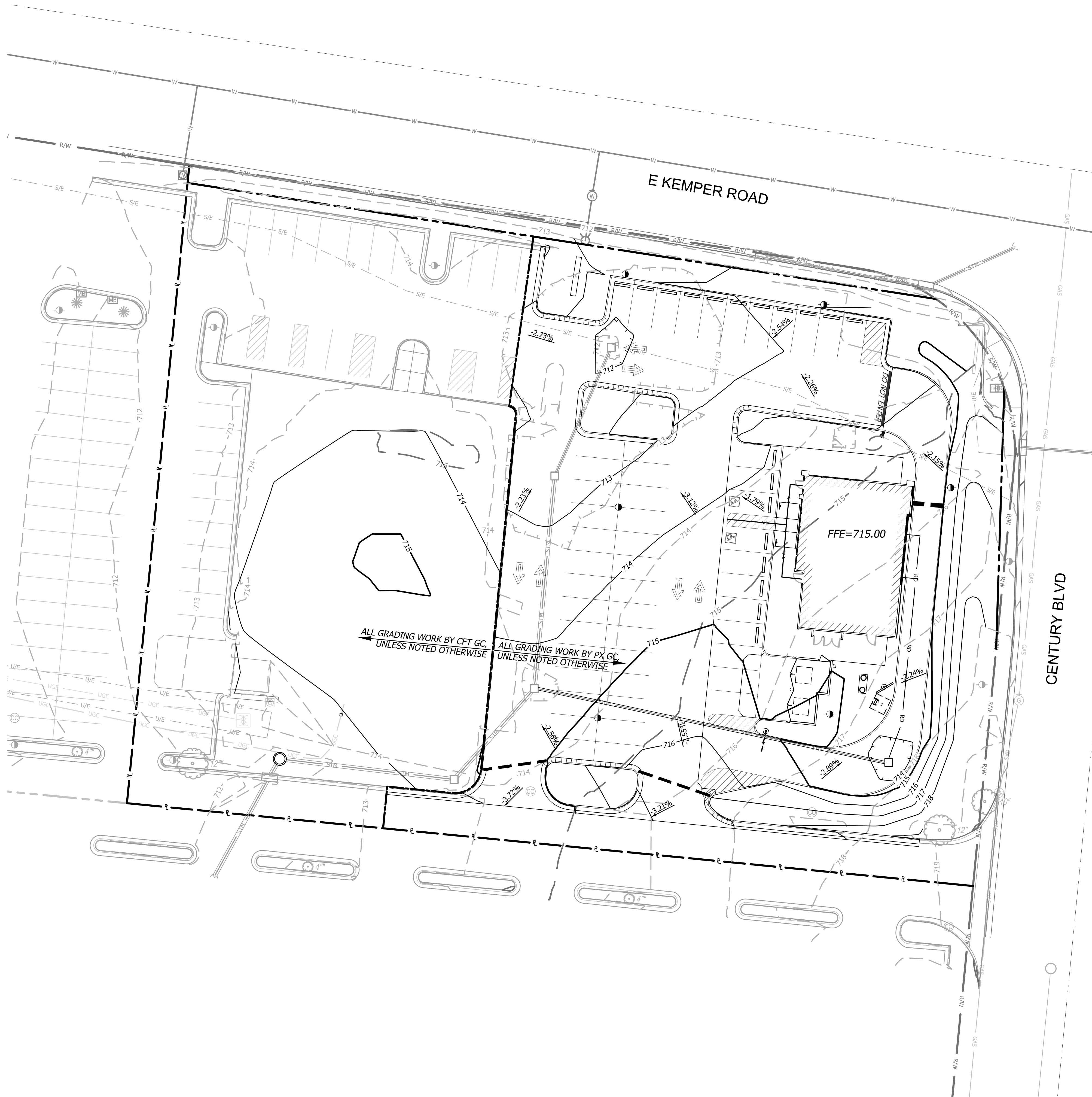

GRADING NOTES

- All proposed contour lines and spot elevations shown are finish ground elevations. Contractor shall account for pavement depths, building pads, topsoil, etc when grading the site.
- All disturbed areas that are not to be paved (green spaces) shall be finish graded with a minimum of six inches of topsoil.
- Finished grades shall not be steeper than 3:1.

FLOOD STATEMENT

The subject property lies within Flood Zone "X" (unshaded) (Areas determined to be outside the 0.2% annual chance floodplain.), as shown on the Hamilton County, Ohio and Incorporated Areas Flood Insurance Rate Map (F.I.R.M.).
Map Number: 39061C0087E
Panel No: 97 of 390
Map Revised Date: February 17, 2010
NOTE: This statement is provided for informational purposes only and shall in no way constitute a basis for a flood certificate. No field work was performed to establish the boundaries of this zone. The information was derived by scaling the subject property on the above referenced map.

BENCHMARKS

(DATUM: NGVD 29)

VERTICAL DATUM IS BASED ON HAMILTON COUNTY MUNUMENT #8373
ELEVATION = 636.67

GRADING LEGEND

- CURB WITH NO GUTTER
- STANDARD CURB & GUTTER
- DRY CURB & GUTTER
- FINISH GRADE MAJOR CONTOURS
- FINISH GRADE MINOR CONTOURS
- EXISTING GRADE MAJOR CONTOURS
- EXISTING GRADE MINOR CONTOURS
- PROPOSED STORM SEWER LINE
- PROPERTY LINE
- RIGHT-OF-WAY LINE
- RIDGE
- ADA PATH

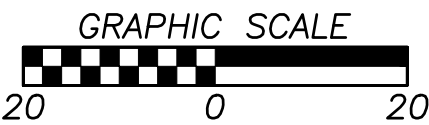
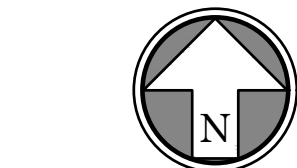

BHC
CIVIL ENGINEERING / SURVEYING / UTILITIES
7101 College Blvd., Suite 400
Overland Park, Kansas 66210
p: (913) 663-1900
f: (913) 663-1900
BHC is a trademark of Benchmark Resources & Company, P.A.



PANDA EXPRESS, INC.
1683 Walnut Grove Ave.
Rosemead, California
91770
Telephone: 626.799.9898
Facsimile: 626.372.8288

All ideas, designs, arrangement and plans indicated or represented by this drawing are the property of Panda Express Inc. and were created for use on this specific project. None of these ideas, designs, arrangements or plans may be used by or disclosed to any person, firm, or corporation without the written permission of Panda Express Inc.

REVISIONS:

ISSUE DATE:

1st	BUILDING PERMIT SET	03-29-21

DRAWN BY: WTG

PANDA PROJECT #: S8-22-D8072
PANDA STORE #: -
ARCH PROJECT #: 20044.009



hckloverarchitect
8813 PENROSE LANE, SUITE 400
LENEXA, KS 66219
ph: 913.649.8181 • fx: 913.649.1275

PANDA EXPRESS
TRUE WARM & WELCOME
E. KEMPER RD & CENTURY BLVD.
CINCINNATI (SPRINGDALE), OH 45246

GRADING PLAN

C3.0

TRUE WARM & WELCOME 2300 R5