

CORNER RECORD

APN No. 84B - 352 - 66 - (Optional) Document Number C.R. 3383
 City of Unincorporated Castro Valley County of ALAMEDA, California
 Brief Legal Description Lot 6, Block 'C', Tract 1094 (31 Maps 56)

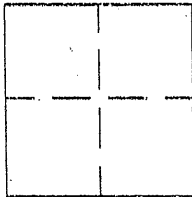

CORNER TYPE

Government Corner ☐ Control ☐
 Meander ☐ Property ☒
 Rancho ☐ Other ☐
 Date of Survey Sept. 12, 2007

COORDINATES (Optional)

N. _____
 E. _____
 Zone _____ Datum _____
 Elev. _____

Corner - Left as found ☐ Found and tagged ☐ Established ☒ Reestablished ☐ Rebuilt ☐

In compliance with Section 8771 of the Professional Land Surveyors' Act, this corner record is being filed to
 ESTABLISH _____ / REESTABLISH _____ the position of an existing monument PRIOR _____ / SUBSEQUENT _____
 to street or highway reconstruction. (Use this portion only when applicable.)

Identification and type of corner found: Evidence used to identify or procedure used to establish or reestablish the corner:

See Map

A description of the physical condition of the monument as found and as set or reset:

See Map

SURVEYOR'S STATEMENT

This Corner Record was prepared by me or under my direction in conformance with

the Land Surveyors' Act on Sept. 18, 2007

Signed Bruce W. Starr L.S. & P.C.E. Number 4392

9-4-08

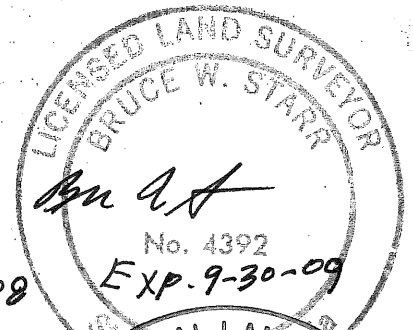

COUNTY SURVEYOR'S STATEMENT

This Corner Record was received 5-19-08 and examined

and filed 5-19-08

Signed Russell R. Penland Title Deputy County Surveyor

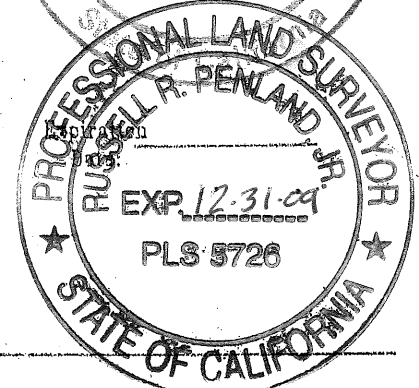

County Surveyor's Comment _____

DRIVE

CAMBRIAN

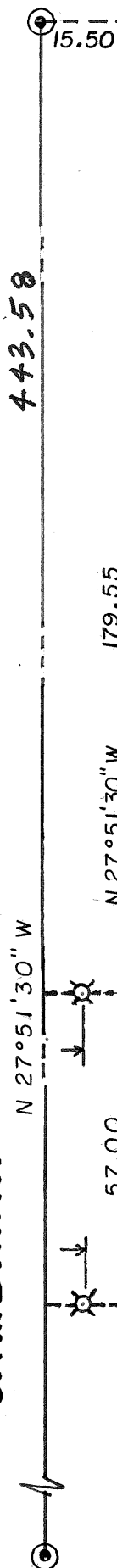

SCALE

1"=30'

LEGEND

- FOUND STANDARD ALAMEDA CO. CONC. MON.
- SET 1/2" REBAR WITH PLASTIC CAP, "L.S.4392"
- ⊗ SET NAIL & BRASS TAG, "L.S.4392" ON CONC.

LOT 5

N 62° 08' 30" E 100.00

8.87

LOT 6
BLOCK C
TRACT 1094

8.93

N 62° 08' 30" E 100.00

LOT 7

N 27° 51' 30" W 57.00